

Courses up Chartiers Cr. }
Beg at a B. St. & running }

- S 30° W 34p
- S 24 W 40p
- S 45 E 14p
- N 72 E 54p
- S 78 E 53p
- S 35 E 16p
- S 47 W 35p
- S 10 W 36p
- S 20 E 18p
- S 21 W 37p
- S 73 W 21p
- S 19 W 37p
- S 45 W 46p
- S 26 W 21p
- S 6° E 18p

to a Sycamore

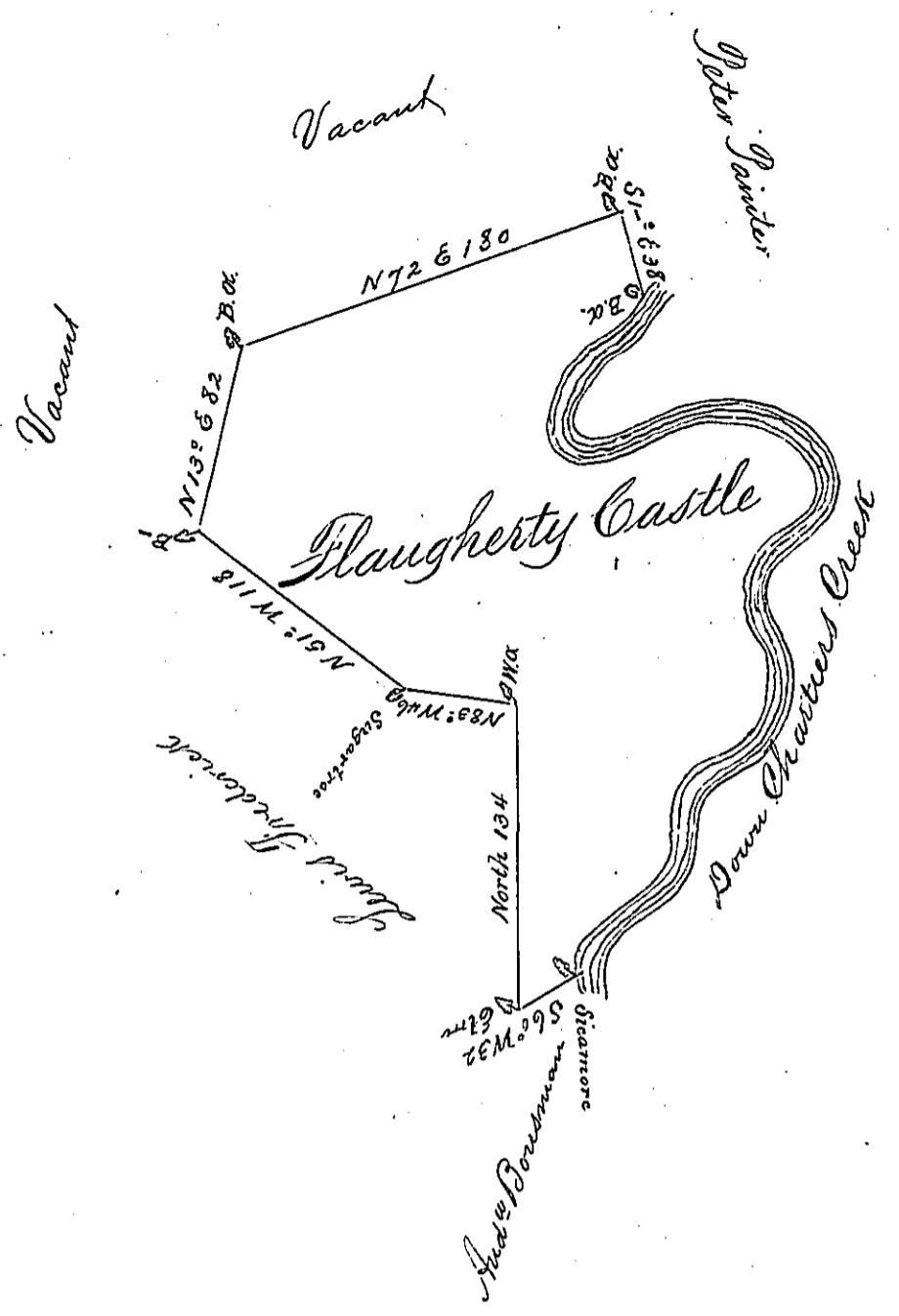

13

In pursuance of an order No. 3055 dated 3^d April 1769, the above is a draught of a tract of land called Flaugherty Castle situated on the West Side Monongahala containing 257.1.12 acres with the usual allowance of 6 p. c. for roads highways &c. surveyed for Michael O'Neal 30th June 1769. by James Hendricks

To
John Lukens Esq^t
Surveyor General

* Say 1055

IN TESTIMONY that the above is a copy of the original remaining on file in the Department of Internal Affairs of Pennsylvania, made conformably to an Act of Assembly approved the 16th day of February, 1833, I have hereunto set my Hand and caused the Seal of said Department to be affixed at Harrisburg, this

eightth day of March 1895

Roac B Brown
Secretary of Internal Affairs.